

PLAN VIEW

--TOPS OF TANKS NOT SHOWN FOR CLARITY--

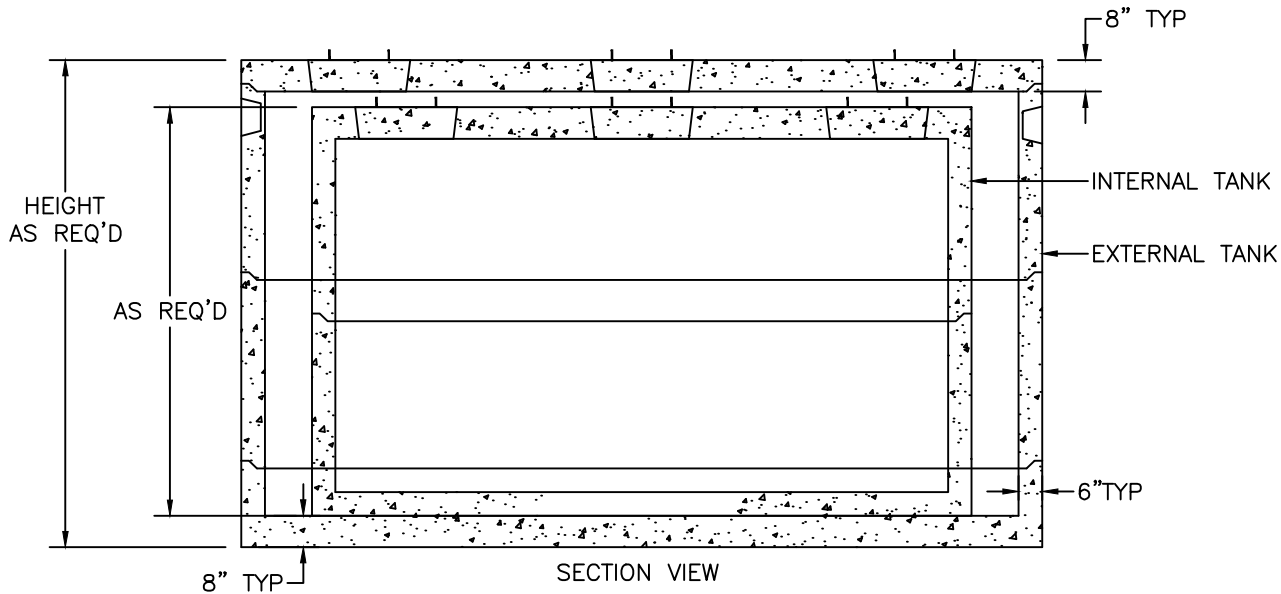

SECTION VIEW

NOTES:

1. CONCRETE: 5,000 PSI MINIMUM AFTER 28 DAYS.
2. DESIGN CONFORMS WITH 310 CMR 15.00, DEP TITLE 5 REGS, FOR SEPTIC TANKS.
3. ALL REINFORCEMENT PER ASTM C1227.
4. DESIGNED FOR AASHTO HS-20 LOADING, COVER 1-5 FT.
5. TONGUE AND GROOVE JOINT SEALED WITH BUTYL RESIN. INLET HEIGHT MAY INCREASE SLIGHTLY DUE TO THE BUTYL RESIN USED.

SHEA PRODUCT ID: VARIES	PREPARED FOR:	FILE NAME: Double Cell Tank.dwg	
WEIGHT (LBS): VARIES	DRAWN BY: ARO	DATE: 03/01/2018	
773 Salem Street-Wilmington, MA 153 Cranberry Hwy-Rochester, MA 87 Haverhill Road-Amesbury, MA 160 Old Turnpike Rd-Nottingham, NH			