

WEIGHT	RISERS							
	WIDTH	1	2	3	4	5	6	7
4'	655#	1,050#	1,490#	1,975#	2,500#	3,070#		
5'	795#	1,240#	1,730#	2,260#	2,835#	3,450#	4,110#	
6'	940#	1,430#	1,965#	2,545#	3,170#	3,830#	4,540#	
7'	1,055#	1,600#	2,190#	2,820#	3,500#	4,220#	4,990#	

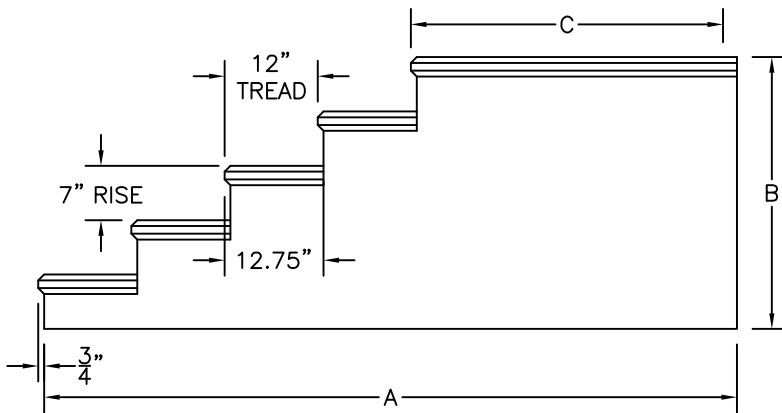

SIDE VIEW

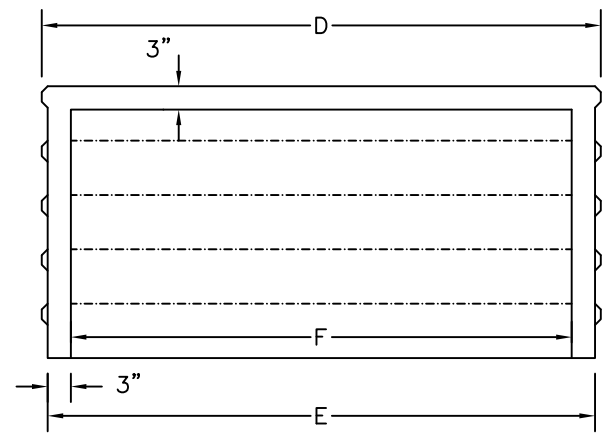

END VIEW

RISER	A NO PLAT	A 42\"/>	
1	12"	41 $\frac{1}{4}$ "	7"
2	24"	53 $\frac{1}{4}$ "	14"
3	36"	65 $\frac{1}{4}$ "	21"
4	48"	77 $\frac{1}{4}$ "	28"
5	60"	89 $\frac{1}{4}$ "	35"
6	72"	101 $\frac{1}{4}$ "	42"
7*	84"	113 $\frac{1}{4}$ "	49"

D WIDTH	E OUTSIDE CORE WIDTH	F INSIDE CORE WIDTH	C PLATFORM LENGTH
4'	47"	42"	42"
5'	59"	53 $\frac{1}{2}$ "	42"
6'	71"	65 $\frac{1}{2}$ "	42"
7'	82"	78"	42"

NOTES:

1. CONCRETE: 4,000 PSI MINIMUM AFTER 28 DAYS.
2. WROUGHT IRON RAILS OPTIONAL.
3. TREADS AND PLATFORM BROOM FINISHED.
- *4. 7 RISER NOT AVAILABLE IN 4' WIDE.



New England's Premier Precaster
 800-696-7432 (SHEA)
 www.sheaconcrete.com

STEPS STANDARD-7" RISE
 WIDTH: 4', 5', 6', 7'

773 Salem Street-Wilmington, MA 153 Cranberry Hwy-Rochester, MA
 87 Haverhill Road-Amesbury, MA 160 Old Turnpike Rd-Nottingham, NH
 Mail to: PO Box 520-Wilmington, MA 01887

Page: A1.2

steps7.dwg

3/18/2011

