

ISOMETRIC
 N.T.S.

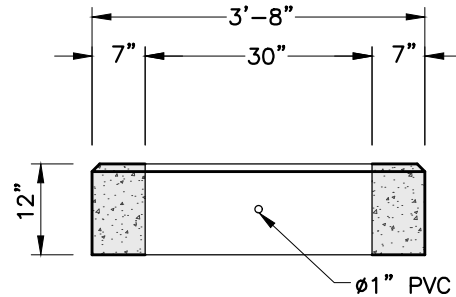
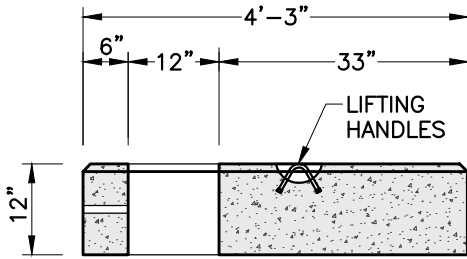

NOTES:

1. CONCRETE MINIMUM STRENGTH 4,000 PSI AFTER 28 DAYS.
2. REINFORCEMENT STEEL CONFORMS TO ASTM A615 GRADE 60 #6 REBAR.
3. MEETS OR EXCEEDS EVERSOURCE SPECIFICATIONS.

SHEA PRODUCT ID: 25-75 KVA

FILE NAME: ES-NH TP 53-102

WEIGHT (LBS): 1,936#

DRAWN BY: MNN

DATE: 01/02/2018

PAGE: III.C.1

